



Read this Owner's Manual thoroughly before operating the equipment. Keep it with the equipment at all times. Replacements are available from Thern, Inc., PO Box 347, Winona, MN 55987, 507-454-2996. www.thern.com

IMPORTANT: Please record product information on page 2. This information is required when calling the factory for service.



Owner's Manual

For
5123 Series
PorTable Davit Cranes

Two-Year Limited Warranty

Please record the following:

Date Purchased: _____

Crane Model No.: _____

Crane Serial No.: _____

If sold with a winch:

Winch Model No.: _____

Winch Serial No.: _____

This information is required when calling the factory for service.

Thern, Inc. warrants its products against defects in material or workmanship for two years from the date of purchase by the original using buyer, or if this date cannot be established, the date the product was sold by Thern, Inc. to the dealer. To make a claim under this warranty, contact the factory for an RGA number. The product must be returned, prepaid, directly to Thern, Inc., 5712 Industrial Park Road, Winona, Minnesota 55987. The following information must accompany the product: the RGA number, the date of purchase, the description of the claimed defect, and a complete explanation of the circumstances involved. If the product is found to be defective, it will be repaired or replaced free of charge, and Thern, Inc. will reimburse the shipping cost within the contiguous USA.

This warranty does not cover any damage due to accident, misuse, abuse, or negligence. Any alteration, repair or modification of the product outside the Thern, Inc. factory shall void this warranty. This warranty does not cover any costs for removal of our product, downtime, or any other incidental or consequential costs or damages resulting from the claimed defects. This warranty does not cover brake discs, wire rope or other wear components, as their life is subject to use conditions which vary between applications.

FACTORY AUTHORIZED REPAIR OR REPLACEMENT AS PROVIDED UNDER THIS WARRANTY IS THE EXCLUSIVE REMEDY TO THE CONSUMER. THERN, INC. SHALL NOT BE LIABLE FOR ANY INCIDENTAL OR CONSEQUENTIAL DAMAGES FOR BREACH OF ANY EXPRESS OR IMPLIED WARRANTY ON THIS PRODUCT. EXCEPT TO THE EXTENT PROHIBITED BY APPLICABLE LAW, ANY IMPLIED WARRANTY OF MERCHANTABILITY OR FITNESS FOR A PARTICULAR PURPOSE ON THIS PRODUCT IS LIMITED IN DURATION TO THE DURATION OF THIS WARRANTY.

Some states do not allow the exclusion or limitation of incidental or consequential damages, or allow limitations on how long an implied warranty lasts, so the above limitation or exclusion may not apply to you. This warranty gives you specific legal rights, and you may also have other rights which vary from state to state.

Note: Thern, Inc. reserves the right to change the design or discontinue the production of any product without prior notice.

About This Manual

The Occupational Safety and Health Act of 1970 states that it is the employer's responsibility to provide a workplace free of hazard. To this end, all equipment should be installed, operated, and maintained in compliance with applicable trade, industrial, federal, state, and local regulations. It is the equipment owner's responsibility to obtain copies of these regulations and to determine the suitability of the equipment to its intended use.

This Owner's Manual, and warning labels attached to the equipment, are to serve as guidelines for hazard-free installation, operation, and maintenance. They should not be understood to prepare you for every possible situation.

The information contained in this manual is applicable only to the Thern 5123 Series PorTable Davit Cranes. Do not use this manual as a source of information for any other equipment.

The following symbols are used for emphasis throughout this manual:

▲WARNING

Failure to follow 'WARNING!' instructions may result in equipment damage, property damage, and/or serious personal injury.

▲CAUTION

Failure to follow 'CAUTION!' instructions may result in equipment damage, property damage, and/or minor personal injury.

Important!

Failure to follow 'important!' instructions may result in poor performance of the equipment.

Suggestions for Safe Operation

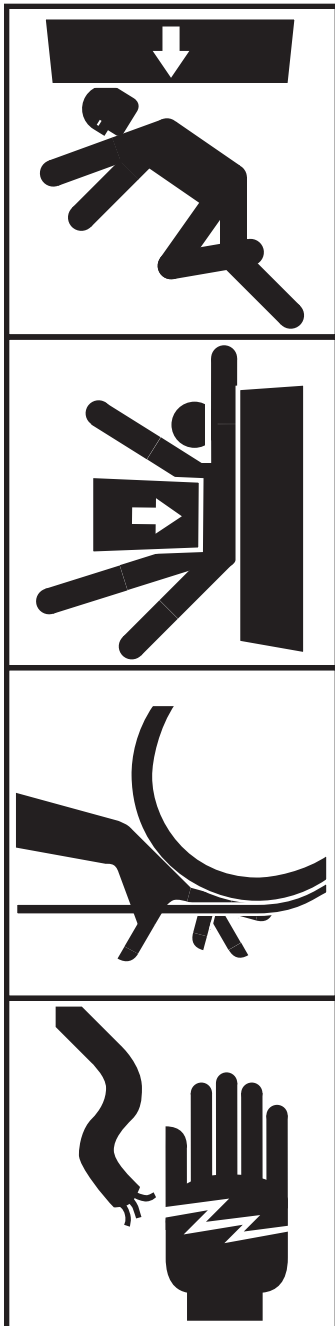

⚠️WARNING

DO the following:

Read and comply with the guidelines set forth in this Owner's Manual. Keep this manual, and all labels attached to the crane, readable and with the equipment at all times. Contact Thern, Inc. for replacements.

Check lubrication before use.

Install the wire rope securely to the winch drum.

Keep at least 4 wraps of wire rope wound on the drum at all times, to serve as anchor wraps. With less than 4 wraps on the drum the wire rope could come loose, causing the load to escape.

Keep hands away from sheaves, gears, wire rope, and other moving parts of the equipment.

Disconnect the power before servicing the equipment.

Keep all unnecessary personnel away from the crane while in operation. Keep out of the path of the load, and out of the path of a broken wire rope that might snap back and cause injury.

DO NOT do the following:

Do not lift people, or things over people. Do not walk or work under a load or in the line of force of any load.

Do not exceed the load rating of the crane or any other component in the system. To do so could result in failure of the equipment.

Do not use more than one crane to move a load that exceeds the load rating of a single crane. A shift in load weight could overload the equipment.

Do not use damaged or malfunctioning equipment. To do so could result in failure of the equipment.

Do not modify the equipment in any way. To do so could cause equipment failure.

Do not wrap the wire rope around the load. This damages the wire rope and could cause the load to escape. Use a sling or other approved lifting device.

Do not operate the crane with guards removed or improperly installed.

Do not divert your attention from the operation. Stay alert to the possibility of accidents, and try to prevent them from happening.

Do not jerk or swing the load. Avoid shock loads by starting and stopping the load smoothly. Shock loads overload the equipment and may cause damage.

Do not remove the winch or other components from the crane, and do not use these components for any use other than for their original intended function.

Do not use the crane to drag or pull loads. This will create side pulls which could damage the equipment or cause the load to tip.

Do not leave a suspended load unattended. Place the load on the ground if it must be left unattended.

Do not adjust the winch brake with the load suspended.

1.1 Installing the Crane

Important!

- A qualified professional should inspect or design the foundation to insure that it will provide adequate support.
- Locate the crane so it will be visible during the entire operation.

⚠WARNING

Do not install the crane in an area defined as hazardous by the National Electric Code, unless installation in such an area has been thoroughly approved.

Do not install the crane near corrosive chemicals, flammable materials, explosives, or other elements that may damage the crane or injure the operator. Adequately protect the crane and the operator from such elements.

Position the crane so the operator can stand clear of the load, and out of the path of a broken wire rope that could snap back and cause injury.

Attach the crane to a rigid and level foundation that will support the crane and its load under all load conditions, including shock loading.

- 1.1.1 CONSULT APPLICABLE CODES AND REGULATIONS for specific rules on installing the equipment.
- 1.1.2 LOCATE THE CRANE in an area clear of traffic and obstacles that could interfere with operation. Make sure the crane is accessible for maintenance and operation.
- 1.1.3 INSTALL THE CRANE on a level surface. **An unlevel surface may cause the boom to rotate in the direction the mast is leaning.**
- 1.1.4 FASTEN THE BASE securely to the foundation.
 - a For Standard products referred to in this manual, use 5/8-inch coarse thread fasteners, grade 5 or better. Torque for grade 5 fasteners without lubrication is 150 ft. lbs. Make sure mounting holes are secured to a solid foundation able to support the crane and the load under all conditions with design factors based on accepted engineering practices.
 - b Non-standard products that vary from the original design may have different fastening requirements. Contact a professional engineer or Thern, Inc for this information.

TO COMPLY WITH LOCAL CODES, CONTACT A QUALIFIED PROFESSIONAL TO OBTAIN PROPER STRUCTURE OR FOUNDATION SPECIFICATIONS FOR THE MOUNTING OF THERN PRODUCTS.

1.2 Assembling the Crane

Important!

- Inspect the crane during assembly according to the Instructions for Periodic Inspection. This will give you a record of the condition of the crane with which to compare future inspections.
- Save all boxes and crates that the crane was shipped in, use them again if you need to repackage the crane.
- Contact the factory immediately if any parts are missing or damaged.
- Do not overtighten fasteners, this may strip threads or cause damage to other parts.

- 1.2.1 STUDY PARTS DRAWINGS to understand how the crane is assembled. See page 16.
- 1.2.2 LUBRICATE PINS and other components prior to assembly. See Section 3.2 Lubricating the Crane.
- 1.2.3 INSTALL THE BASE and then assemble the crane in the following order:
 - a INSTALL THE MAST in the base.
 - b FASTEN THE BOOM to the mast using the hitch pin and fasteners provided. **Make sure the boom is positioned correctly.**
 - c SLIDE THE BOOM EXTENSION into the boom, and secure in place with the hitch pin and fasteners provided. **Make sure the boom extension is positioned correctly.**
 - d POSITION THE SHEAVE between the ears on the boom extension, and fasten in place with the headless pin and cotter pins provided.
 - e INSTALL THE CLEVIS PINS in the holes located above the sheave at the end of the boom extension. Secure in place with the cotter hairpins provided.
 - f INSTALL THE HANDLE on the lower end of the boom, using the fasteners provided.
- 1.2.4 FASTEN THE WINCH to the mounting plate on the boom using the fasteners provided. On some models you will need to use the mounting plate assembly and fasteners provided to fasten the winch to the crane. See page 17. **Make sure the winch is positioned correctly.**
- 1.2.5 INSTALL THE WINCH HANDLE on hand winches, or connect electric current on power winches. Refer to instructions in the Winch Owner's Manual.
- 1.2.6 INSTALL THE WIRE ROPE. **Use wire rope assemblies in the length specified on page 19.**
 - a PASS THE WIRE ROPE over the sheave at the end of the boom.
 - b ANCHOR THE WIRE ROPE to the winch drum and wind 4 wraps of wire rope onto the drum to act as anchor wraps. Refer to the instructions in the Winch Owner's Manual.
- 1.2.7 MAKE SURE ALL FASTENERS are tightened, and cotter pins properly bent to secure them in place. See Figure 1.

Figure 1 – Cotter Pins

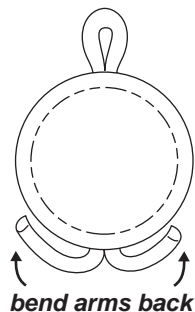

2.1 General Theory of Operation

Important!

- Limit nonuniform winding by keeping tension on the wire rope.
- It is your responsibility to detect and account for different factors affecting the condition and performance of the equipment.

- 2.1.1 THE PULL REQUIRED to move the load must not exceed the load rating of the crane. Consider the total force required to move the load, not the weight of the load.
- 2.1.2 THIS EQUIPMENT CAN develop forces that will exceed the load rating. It is the responsibility of the equipment user to limit the size of the load. Inspect the equipment regularly for damage according to the instructions contained in this manual.
- 2.1.3 PERFORMANCE RATINGS of the equipment are affected by the position of the boom, and the amount of wire rope you use. See the Performance Characteristics Tables.
- a LOAD RATING represents the maximum pull that can be placed on new equipment. Load ratings are assigned values for specific boom positions and wire rope lengths. **Crane load ratings decrease as you extend the boom. See the Performance Characteristics Tables, see page 19.**
- b LIFT varies with the position of the boom and the length of the wire rope.
- c REACH varies with the position of the boom.
- 2.1.4 DUTY RATINGS refer to the type of use the equipment is subject to. Consider the following when determining duty rating.
- a ENVIRONMENT: harsh environments include hot, cold, dirty, wet, corrosive, or explosive surroundings. **Protect the equipment from harsh environments when possible.**
- b MAINTENANCE: poor maintenance, meaning poor cleaning, lubrication, or inspection, leads to poor operation and possible damage of the equipment. **Minimize poor maintenance by carefully following the instructions contained in this manual.**
- c LOADING: severe loading includes shock loading and moving loads that exceed the load rating of the equipment. **Avoid shock loads, and do not exceed the load rating of the equipment.**
- d FREQUENCY OF OPERATION: frequent or lengthy operations increase wear and shorten the life span of gears, bearings, sheaves, and other components. **Increase maintenance of the equipment if used in frequent operations.**

CONTACT THE FACTORY FOR MORE INFORMATION.

2.3 Preparing for Operation

Important!

- When determining whether the load will exceed the load rating, consider the total force required to move the load.

- 2.3.1 **CONSIDER THE OPERATION.** Do not begin until you are sure you can perform the entire operation without hazard.
- 2.3.2 **INSPECT ALL COMPONENTS** of the system.
- INSPECT THE CRANE** and other equipment according to the Instructions for Frequent Inspection.
 - INSPECT THE WINCH** according to the instructions in the Winch Owner's Manual.
 - OPERATORS** must be in good health, alert, thoroughly trained in operating the equipment, and properly clothed (hard hat, safety shoes and safety glasses, no loose clothing).
 - THE LOAD** must be clear of other objects and free to move. Make sure the load will not tip, spin, roll away, or in any way move uncontrollably.
- 2.3.3 **KNOW YOUR LOAD** and make sure you do not exceed the load rating of the crane or any other equipment in the system.
- 2.3.4 **POSITION THE BOOM** so the load hook is centered over the load. **Avoid side pulls which could damage the crane or cause the load to tip. See Figure 2.**
- ADJUST BOOM LENGTH** by moving the boom extension in or out. **The load rating decreases as you increase boom length. See the Performance Characteristics Tables.**
 - ADJUST BOOM ANGLE** by removing the hitch pin without load attached to crane. Reinsert hitch pin at desired boom angle. **The lift height below base level decreases as you raise the boom. See the Performance Characteristics Tables.**

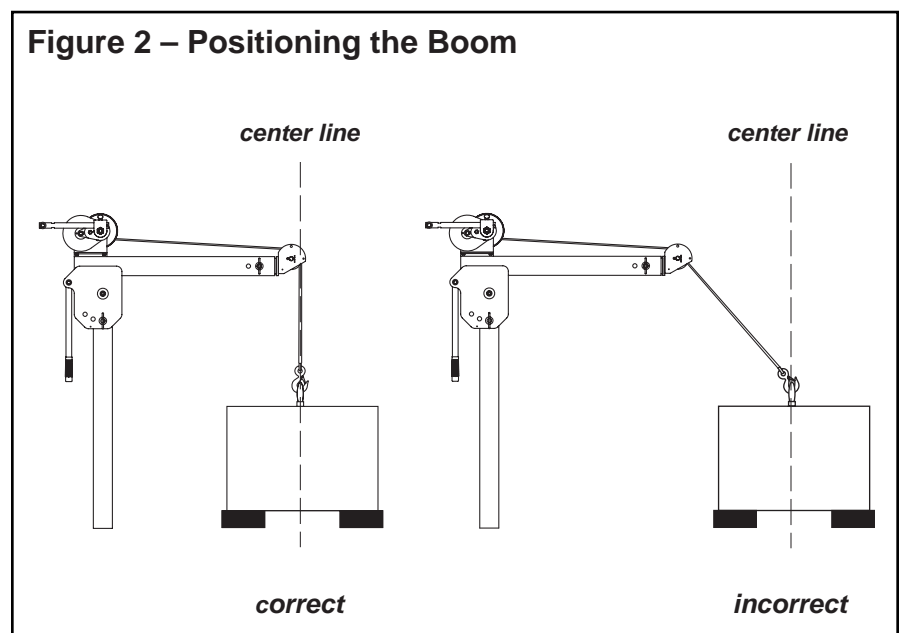

2.4 Attaching the Load

⚠ WARNING

Do not wrap the wire rope around the load. This damages the wire rope and could cause the load to escape. Use a sling or other approved lifting device.

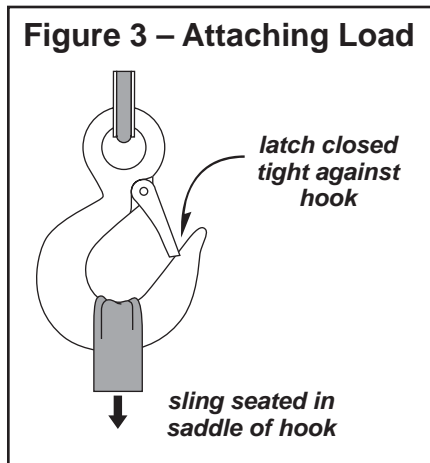

- 2.4.1 CLEAR OBJECTS from the path of the load so you can move it freely and observe it at all times during the operation.
- 2.4.2 MAKE SURE THE WIRE ROPE is not twisted. A twisted wire rope could cause the load to spin when it is raised off the ground.
- 2.4.3 ATTACH THE LOAD using a nylon sling, or other approved lifting device. Follow the recommendations of the sling manufacturer.
- a SEAT THE SLING in the saddle of the hook with the hook latch completely closed. See Figure 3.
 - b CENTER THE LOAD on the hook so it will remain balanced and not tip or rotate to one side.

2.5 Moving the Load

Important!

- Obey a stop signal from anyone.
- Maintain tension on the wire rope to keep it tightly and evenly wound on the drum.
- If the crane and load are not visible during the entire operation, get help from another person.
- Appoint a supervisor if more than one person is involved in the operation. This will reduce confusion and increase safety.
- When lifting a load, use a tag line to keep the load from swinging or twisting, while keeping yourself away from the load.

- 2.5.1 MOVE THE LOAD slowly and smoothly, only a small distance at first. Make sure the load is balanced and securely attached before continuing.
- 2.5.2 OPERATE THE WINCH to raise or lower the load. Refer to the instructions in the Winch Owner's Manual.
- 2.5.3 OBSERVE THE WIRE ROPE as it winds onto the drum. If it becomes loose, uneven, or overlapped, stop the operation and rewind the wire rope before continuing. **Continued operation with overlapped or uneven wire rope can damage the wire rope and shorten its life.**
- 2.5.4 ROTATE THE BOOM to move the load side-to-side.
- a ROTATE THE BOOM slowly and smoothly to avoid swinging the load or causing shock loads. **Do not jam the boom against other objects.**
 - b USE THE HANDLE to rotate the boom. **Do not push or pull the load or the wire rope to rotate the boom.**

3.1 Cleaning the Crane

Important!

Increase the frequency of maintenance procedures if the crane is:

- Operated for long periods.
- Used to lift heavy loads.
- Operated in wet, dirty, hot, or cold surroundings.

Clean the crane to remove dirt and help prevent rust and corrosion.

- 3.1.1 CLEAN THE CRANE every six months or whenever it is dirty.
 - a WIPE ALL EQUIPMENT to remove dirt and grease.
 - b LEAVE A LIGHT FILM of oil on all surfaces to protect against rust and corrosion.
 - c WIPE OFF excessive amounts of oil to avoid the accumulation of dirt.
- 3.1.2 REMOVE UNNECESSARY OBJECTS from the area surrounding the crane.

3.2 Lubricating the Crane

Important!

- Make sure lubricant has a temperature rating appropriate for the ambient temperatures of the operation.

Lubricate the crane properly to help protect it from wear and rust. Read the following instructions carefully.

- 3.2.1 LUBRICATE ALL PINS at least every 6 months. Use a grease brush to apply a light film of NLGI #2 grease to all pins.
- 3.2.2 LUBRICATE ALL BEARINGS AND BUSHINGS at least every 6 months. Apply 2 to 3 drops of 150 grade gear oil to bearings and bushings. Rotate lubricated components to allow oil to penetrate, and wipe off excess oil to avoid accumulation of dirt.
- 3.2.3 LUBRICATE THE WINCH at least every 6 months. Refer to the Winch Owner's Manual for instructions.
- 3.2.4 LUBRICATE THE WIRE ROPE and other equipment by following the manufacturer's recommendations.

3.3 Inspecting the Equipment

Important!

- Start an inspection program as soon as you put the crane into use.
- Appoint a qualified person to be responsible for regularly inspecting the equipment.
- Keep written records of inspection. This allows comparison with comments from previous inspections so you can see changes in condition or performance.

Perform frequent inspections:

- Before each operation.
- Every 3 hours during operation.
- Whenever you notice signs of damage or poor operation.

▲WARNING

Do not use damaged or malfunctioning equipment. Place an “OUT OF ORDER” sign on the crane. Do not use the crane until the sign is removed by a qualified maintenance person who has completely corrected the problem.

Inspect the crane to detect signs of damage or poor operation before they become hazardous. See Table 1 - Inspection Checklist.

3.3.1 CONSULT APPLICABLE CODES AND REGULATIONS for specific rules on inspecting the crane and other equipment.

3.3.2 REFER TO THE WINCH OWNER'S MANUAL for information regarding winch inspection.

3.3.3 Instructions for Frequent Inspection

a VISUALLY INSPECT the entire crane and all other equipment involved in the operation.

- Check all equipment for cracks, dents, bending, rust, wear, corrosion and other damage.
- Make sure the wire rope is installed correctly and anchored securely to the drum.
- Make sure the entire crane is properly lubricated.
- Make sure all fasteners are tight and secure.
- Make sure mounting fasteners are tightened securely.
- Make sure the foundation is in good condition, and capable of supporting the crane and its load under all load conditions.

b TEST CRANE PERFORMANCE by operating the crane with a test load equal to the load rating.

- Listen for unusual noises, and look for signs of damage as you operate the crane.
- Make sure the wire rope winds evenly and tightly onto the drum. If it is loose or uneven, rewind it before continuing.
- Make sure the load moves smoothly, without hesitation or strain.
- On hand operated models, make sure that the winch handle rotates freely in both directions.
- On power operated models, make sure the winch responds to the control device. It must rotate as shown on the control labels, and it must turn off when you release the control.
- Make sure the boom rotates freely when you push it, and remains stationary when you release it.
- Check the brake. Raise the load, then lower it and stop it a few feet off the ground. If the load continues to coast or creep, the brake may be in need of repair or adjustment.

Completely correct all problems before continuing. Use the Troubleshooting Chart to help determine the cause of certain problems. See Table 2.

Perform periodic inspections:

- Every 6 months.
- Whenever you return the crane to service from storage.
- Whenever you notice damage or poor operation in a frequent inspection.
- Whenever you have, or think you may have, overloaded or shock loaded the crane.

Figure 4 – Broken Wires

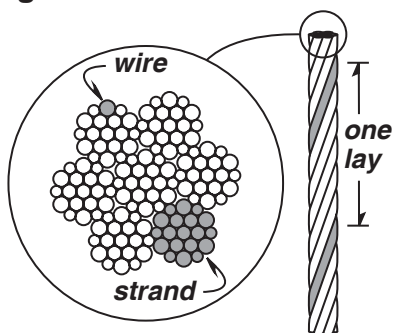

Wire rope assembly must be replaced if more than 6 wires are broken in one lay, or if more than 3 wires are broken in one strand in one lay.

Figure 5 – Load Hook Inspection

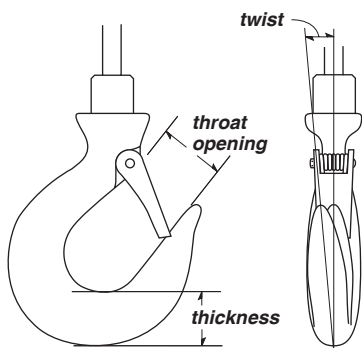

The wire rope assembly must be replaced if the throat opening is 15% wider than nominal, if the thickness is 10% less than nominal, or if the hook is twisted 10° or more.

3.3.4 Instructions for Periodic Inspection

- a VISUALLY INSPECT the crane and all other equipment.
 - Check the finish for wear, flaking, or other damage.
 - Check all equipment for cracks, dents, bending, rust, wear, corrosion and other damage. If the equipment was overloaded, or if you notice cracks or other signs of overloading and damage promptly remove equipment from use and have it repaired or replaced. **DO NOT CONTINUE TO USE DAMAGED OR OVERLOADED EQUIPMENT.**
 - Check all fasteners for stripped threads, wear, bending, and other damage.
 - Make sure the entire crane is properly lubricated.
 - Make sure all labels and plates are readable, firmly attached, free of damage and clean. Replacements are available from the factory.
- b INSPECT THE WIRE ROPE according to the wire rope manufacture's recommendations, or follow accepted industry standards for wire rope inspection.
 - Always wear protective clothing when handling wire rope.
 - Check the entire length of wire rope for bent wires, crushed areas, broken or cut wires, corrosion, and other damage. Carefully inspect areas that pass over sheaves or through roller guides.
 - Note the location and concentration of broken wires. Replace wire rope if more than 6 wires are broken in one lay, or more than 3 wires are broken in one strand in one lay. See Figure 4.
 - Make sure the load hook or other device is securely attached to the wire rope, and the wire rope where it is attached is not frayed, corroded, broken, or otherwise damaged.
 - Measure the throat opening, thickness, and twist of the hook. Replace the hook if it shows signs of damage. See Figure 5.
 - Make sure hook latch opens without binding and closes when released.
 - Check the anchor holes in the drum and the surrounding area for signs of wear or distortion.
- c PLACE enough weight to keep the wire rope straight and tightly drawn.
 - Measure the diameter of the wire rope, especially in areas where wear is noticeable. Replace the wire rope if the diameter measures below the minimum diameter at any point. See Figure 6.
- d REMOVE THE WINCH and inspect it by following the instructions in the Winch Owner's Manual.
- e DISASSEMBLE THE CRANE, and inspect each part for damage.
- f REMOVE THE CRANE BASE from the foundation.
 - Check fasteners for stripped threads, wear, bending, and other damage.
 - Check the foundation for cracks, corrosion, and other damage.
- g FASTEN THE CRANE BASE securely to the foundation.
- h REASSEMBLE THE CRANE.

Figure 6 – Rope Diameter

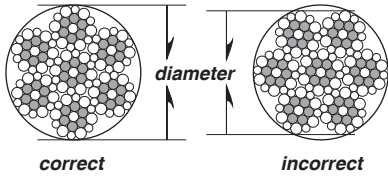

The wire rope assembly must be replaced if the diameter measures less than the minimum diameter at any point.

wire rope diameter	minimum diameter
1/8 in	7/64 in (.1094 in)
3/16 in	11/64 in (.1719 in)
1/4 in	15/64 in (.2344 in)
5/16 in	19/64 in (.2969 in)

- i TEST CRANE PERFORMANCE by operating the crane with a test load equal to the load rating.
 - Listen for unusual noises, and look for signs of damage as you operate the crane.
 - Make sure the wire rope winds evenly and tightly onto the drum. If it is loose or uneven, rewind it before continuing.
 - Make sure the load moves smoothly, without hesitation or strain.
 - On hand operated models, make sure that the winch handle rotates freely in both directions.
 - On power operated models, make sure the winch responds to the control device. It must rotate as shown on the control labels, and it must turn off when you release the control.
 - Make sure the boom rotates freely when you push it, and remains stationary when you release it.
 - Check the brake. Raise the load, then lower it and stop it a few feet off the ground. If the load continues to coast or creep, the brake may be in need of repair or adjustment.

Completely correct all problems before continuing. Use the Troubleshooting Chart to help determine the cause of certain problems. See Table 2.

Table 2 – Troubleshooting Chart

problem	cause	correction
overheating	<ul style="list-style-type: none"> • operated too long without rest. • load too heavy • poor lubrication. • bearing seized up 	<ul style="list-style-type: none"> allow to cool lighten load inspect and lubricate as necessary inspect and replace as necessary
boom bounces up and down	<ul style="list-style-type: none"> • load too heavy • mounting bolts loose • sheave worn or damaged. • foundation loose or unlevel • winch gears worn or damaged 	<ul style="list-style-type: none"> lighten load tighten mounting bolts to proper torque inspect and replace as necessary inspect and repair as necessary inspect and repair as necessary
boom does not rotate	<ul style="list-style-type: none"> • rotation points contaminated or worn • flange bearing broken or locked. 	<ul style="list-style-type: none"> inspect and repair as necessary inspect and replace as necessary
boom rotates on its own	<ul style="list-style-type: none"> • foundation loose or unlevel • mast bent, distorted, or leaning. 	<ul style="list-style-type: none"> inspect and repair as necessary inspect and repair as necessary
unusual noises		
high pitched squeak	<ul style="list-style-type: none"> • poor lubrication. 	<ul style="list-style-type: none"> lubricate entire crane properly
grinding noise	<ul style="list-style-type: none"> • contaminated lubricant at rotation points 	<ul style="list-style-type: none"> clean and lubricate rotation points
rattling noise	<ul style="list-style-type: none"> • loose bolts, set screws or other fasteners. 	<ul style="list-style-type: none"> tighten all bolts and other fasteners

Refer to the Winch Owner's Manual for possible problems with the winch and brake.

Table 1 – Inspection Checklist

checked boxes indicate damage or problem in need of repair

	damages	problems
general	<input type="checkbox"/> finish weathered, flaking, otherwise damaged <input type="checkbox"/> parts cracked, bent, rusted, worn, otherwise damaged	<input type="checkbox"/> equipment not properly lubricated <input type="checkbox"/> unusual noises, other signs of malfunction
foundation	<input type="checkbox"/> loose, unstable, otherwise damaged	<input type="checkbox"/> not level - boom swerves
fasteners	<input type="checkbox"/> stripped threads, bent, worn, otherwise damaged	<input type="checkbox"/> loose, not tightened to the proper torque
boom assembly	<input type="checkbox"/> holes worn, distorted, or otherwise damaged	<input type="checkbox"/> does not rotate freely
winch assembly	<input type="checkbox"/> gears, bearings, and other parts worn, otherwise damaged <input type="checkbox"/> brake corroded, cracked, worn, otherwise damaged	<input type="checkbox"/> winch jerks or hesitates under load <input type="checkbox"/> brake does not operate properly
sheave	<input type="checkbox"/> holes worn, distorted, or otherwise damaged	<input type="checkbox"/> does not rotate freely
bearings	<input type="checkbox"/> corroded, worn, seized, or otherwise damaged	<input type="checkbox"/> not properly lubricated
wire rope	<input type="checkbox"/> bent, crushed, otherwise damaged <input type="checkbox"/> broken wires, see Figure 4 replace if more than 6 wires in one lay, or 3 wires in one strand in one lay, are broken <input type="checkbox"/> diameter reduced, see Figure 6 replace if diameter is excessively worn	<input type="checkbox"/> wire rope loosely or unevenly wound number per strand = _____ number per lay = _____ diameter = _____
end connections	<input type="checkbox"/> corroded, rusted, worn, otherwise damaged	<input type="checkbox"/> not securely attached
load hook	<input type="checkbox"/> twisted, bent, worn, otherwise damaged, see Figure 5 replace if twist is 10 degrees or more replace if throat width is 15% larger than nominal replace if thickness is 10% less than nominal	<input type="checkbox"/> hook latch fails to close when released twist = _____ throat width = _____ thickness = _____
labels and plates	<input type="checkbox"/> dirty, illegible, otherwise damaged	<input type="checkbox"/> loosely attached or missing

comments:

authorized signature: _____ date _____

3.4 Repairing the Crane

Important!

- It is your responsibility to determine when to replace parts. When considering whether to continue using a part or to replace it, remember that replacing it is the best way to avoid further equipment damage.
- Appoint a qualified person to be responsible for all repairs to the equipment.

- 3.4.1 GET FACTORY AUTHORIZATION for all repairs. Unauthorized repairs will void the warranty, and may lead to damage or failure of the crane.
- 3.4.2 REPLACE DAMAGED OR POORLY OPERATING PARTS with Thern repair parts.
- 3.4.3 REFINISH AREAS where the paint is worn or flaking. A good finish helps to protect against corrosion and weather damage.
 - a REMOVE THE FINISH from damaged areas, down to the bare metal.
 - b CLEAN THE AREA thoroughly.
 - c REPAINT with a high quality primer and finishing coat.
- 3.4.4 TO ORDER REPAIR PARTS, contact your local dealer. Include the following information when ordering:
 - model number
 - serial number (or code number)
 - part number
 - date purchased, and from whom
 - description of what happened, or what is wrong
 - your name and return address

4.1 Transporting the Crane

Important!

- Keep a record of what you ship, and when you send it.

- 4.1.1 PARTIALLY DISASSEMBLE THE CRANE into parts that can be easily transported.
- 4.1.2 PACK THE CRANE for transport, using the original packaging materials, if appropriate.
- 4.1.3 REASSEMBLE THE CRANE at its new location following the instructions in section 1.2 Assembling the Crane.
- 4.1.4 INSPECT THE CRANE according to Section 3.3.3 Instructions for Frequent Inspection before installing it for operation.

4.2 Storing the Crane

- 4.2.1 DISASSEMBLE THE CRANE and store all parts in a cool clean place away from corrosive chemicals and moisture.
- 4.2.2 SEAL THE CRANE in plastic with a desiccant to help protect it from rust, corrosion, and other damage.
- 4.2.3 REASSEMBLE THE CRANE at its new location following the instructions under Assembling the Crane.
- 4.2.4 INSPECT THE CRANE according to the Instructions for Periodic Inspection before installing it for operation.

5123 Series PorTable Davit Cranes		5123 Series Red Fusibond		5123GAL Series Galvanized Finish		5123SS Series Stainless Steel	
item	description	part number	qty.	part number	qty.	part number	qty.
1	BOOM	C2900RED	1	C2900GAL	1	C2953	1
2	CLEVIS PIN .750 X 3.625 SST	A6885	1	A6885	1	A6885	1
3	COTTER HAIR PIN .500/.625 X .148 DIA SST	A2838	1	A2838	1	A2838	1
4	BOOM EXTENSION	C2899RED	1	C2899GAL	1	C2955	1
5	CLEVIS PIN .250 X 1.734 SST	A6905	1	A6905	1	A6905	1
6	COTTER HAIR PIN .188/.250 X .042 SST	A6452	1	A6452	1	A6452	1
7	CLEVIS PIN .750 X 1.765 SST	A4438	1	A4438	1	A4438	1
8	COTTER PIN .125 X 1.250 SST	A4305	1	A4309	1	A4309	1
9	SHEAVE ASSEMBLY	B2462	1	B2462	1	B2462	1
10	CLEVIS PIN .750 X 4.625 SST	A7257	2	A7257	2	A7257	2
11	MAST	C2901RED	1	C2901GAL	1	C2954	1
12	BLACK PLASTIC HANDLE GRIP	A6061	1	A6061	1	A6061	1
13	HANDLE	A6054RED	1	A6054GAL	1	A6248	1
14	CAPSCREW HEXHD .375-16NC X 5.000 SST	A4217	1	A4217	1	A4217	1
15	HEX NUT NYLK .375-16NC SST	A3356	1	A3356	1	A3356	1
16	FLAT WASHER .375 X .750 X .125 SST	A1907	2	A1907	2	A1907	2
17	SPACER SST	A6904	2	A6904	2	A6904	2
18	WARNING LABEL	A1961	1	A1961	1	A1961	1
19	IMPORTANT INSERT PIN LABEL	A2188	4	A2188	4	A2188	4
20	NAMEPLATE LABEL SST	A1976	1	A1976	1	A1976	1
21	LOAD RATING LABEL	A6211	2	A6211	2	A6211	2
22 ¹	MACHINE SCREW RNDHDSL 10-24NC X .375	A3879	2	A3879	2	-	-
23 ¹	FLAT WASHER #10 X .500 X .049	A1059	2	A1059	2	-	-
24 ¹	LYNCH PIN WITH LANYARD	A6628	1	A6628	1	-	-
25 ¹	LYNCH PIN WITH LANYARD	A6630	1	A6630	1	-	-

¹ Items 22, 23, 24 and 25 are not shown in parts drawing.

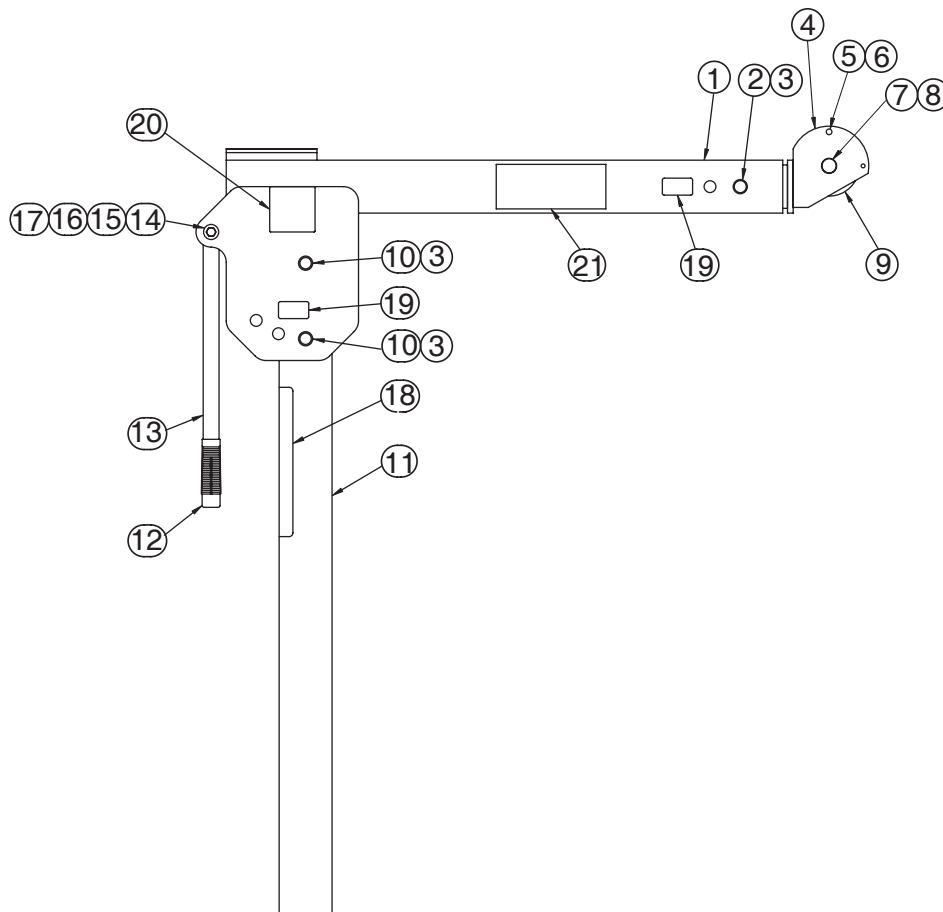

5123M1 Series Winch		5123M1		5123M1GAL		5123M1SSA		5123M1SSB	
item	description	part number	qty.	part number	qty.	part number	qty.	part number	qty.
1	HAND WINCH	M4312PB-K	1	M4312PB-K	1	M4312PBSS-K	1	M4312PB-K	1
2	CAPSCREW HEXHD	A3355	4	A3355	4	A3355	4	A3355	4
3	HEX NUT	A3356	4	A3356	4	A3356	4	A3356	4

5123E4 Series Winch		5123E4 Red Fusibond		5123E4GAL Galvanized Finish		5123E4SSA Stainless Steel	
item	description	part number	qty.	part number	qty.	part number	qty.
4	POWER WINCH	4777-K	1	4777-K	1	4777-K	1
5	MOUNTING PLATE ASSEMBLY	C3114	1	C3114GAL	1	C3114	1
5a	MOUNTING PLATE	C3111RED	1	C3111GAL	1	C3111RED	1
5b	CAPSCREW HEXHD .375-16NC X .750	A2975	4	A2975	4	A2975	4
5c	WASHER HELSPRLK .375 X .683 X .094	A2926	4	A2926	4	A2926	4
5d	CAPSCREW HEXHD .312-18NC X 2.000	A5042	6	A5042	6	A5042	6
5e	HEX NUT NYLK .312-18NC	A2927	6	A2927	6	A2927	6
5f	FLAT WASHER SAE .312 X .688 X .065	A2924	6	A2924	6	A2924	6

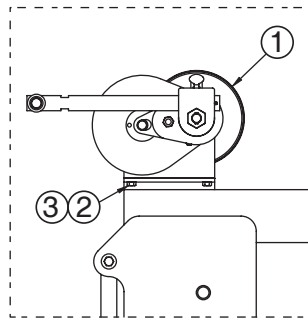

5123M1 Series

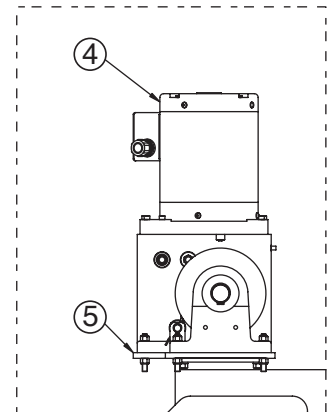

5123E4 Series

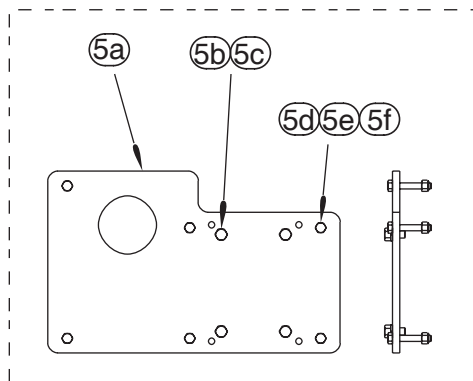

C3114 Mounting Plate Assembly

523 Series Pedestal Base		523		523GAL		523SS	
item	description	part number	qty	part number	qty	part number	qty
1	BASE	C2887	1	C2887	1	C2616	1
2	FLANGE BEARING 3.562ID X 4.50OD X 2.50 NYLATRN	B2450	1	B2450	1	B2450	1

523F Series Socket Base		523F		523FGAL		523SSF	
item	description	part number	qty	part number	qty	part number	qty
1	BASE	C2883	1	C2883	1	C2737	1
2	FLANGE BEARING 3.562ID X 4.50OD X 2.50 NYLATRN	B2450	1	B2450	1	B2450	1

523W Series Wall Base		523W		523WGAL		523SSW	
item	description	part number	qty	part number	qty	part number	qty
1	BASE	C3224	1	C3224	1	C3485	1
2	FLANGE BEARING 3.562ID X 4.50OD X 2.50 NYLATRN	B2450	1	B2450	1	B2450	1

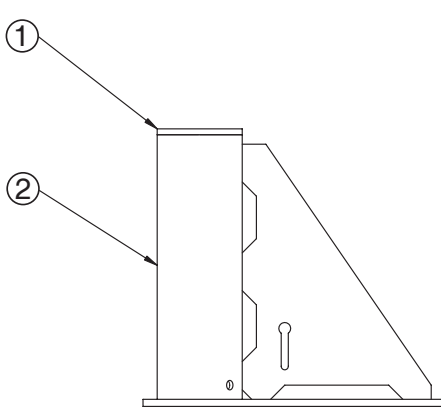

523 Series Pedestal Base

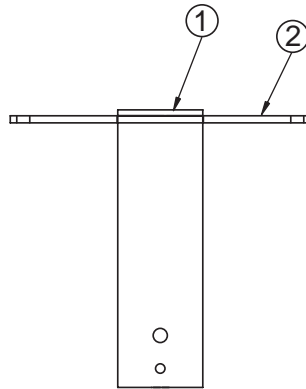

523F Series Socket Base

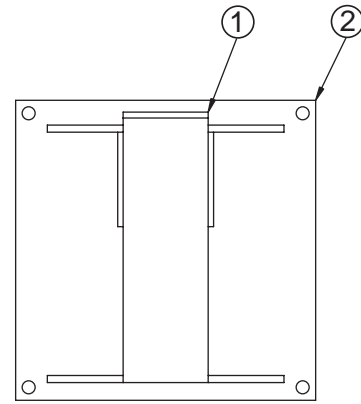

523W Series Wall Base

5123 Series Performance Characteristics												
Models 5123M1 and 5123M1GAL			load rating (lb)					lift below base level ² (ft) ²				
wire rope diameter	wire rope length	boom angle	boom extension					boom extension				
			1	2	3	4	5	1	2	3	4	5
1/4 in	20 ft	A	850	850	800	750	725	10	10	10	10	9
1/4 in	20 ft	B	1025	1000	950	875	850	9	9	8	8	8
1/4 in	20 ft	C	1400	1325	1225	1175	1100	8	8	8	7	7
1/4 in	28 ft	A	850	850	800	750	725	18	18	18	18	17
1/4 in	28 ft	B	1025	1000	950	875	850	17	17	16	16	16
1/4 in	28 ft	C	1400	1325	1225	1175	1100	16	16	16	15	15
1/4 in	36 ft	A	850	850	800	750	725	26	26	26	26	25
1/4 in	36 ft	B	1025	1000	950	875	850	25	25	24	24	24
1/4 in	36 ft	C	1400	1325	1225	1175	1100	24	24	24	23	23
1/4 in	45 ft	A	850	850	800	750	725	35	35	35	35	34
1/4 in	45 ft	B	1025	1000	950	875	850	34	34	33	33	33
1/4 in	45 ft	C	1400	1325	1225	1175	1100	33	33	33	32	32
5123M1SSA			load rating (lb)					lift below base level ² (ft) ²				
wire rope diameter	wire rope length	boom angle	boom extension					boom extension				
			1	2	3	4	5	1	2	3	4	5
1/4 in	20 ft	A	850	850	800	750	725	10	10	10	10	9
1/4 in	20 ft	B	1025	1000	950	875	850	9	9	8	8	8
1/4 in	20 ft	C	1300	1300	1225	1175	1100	8	8	8	7	7
1/4 in	28 ft	A	850	850	800	750	725	18	18	18	18	17
1/4 in	28 ft	B	1025	1000	950	875	850	17	17	16	16	16
1/4 in	28 ft	C	1100	1100	1100	1100	1100	16	16	16	15	15
1/4 in	36 ft	A	850	850	800	750	725	26	26	26	26	25
1/4 in	36 ft	B	1000	1000	950	875	850	25	25	24	24	24
1/4 in	36 ft	C	1000	1000	1000	1000	1000	24	24	24	23	23
1/4 in	45 ft	A	850	850	800	750	725	35	35	35	35	34
1/4 in	45 ft	B	900	900	900	875	850	34	34	33	33	33
1/4 in	45 ft	C	900	900	900	900	900	33	33	33	32	32
5123E4 and 5123E4DC			load rating (lb)					lift below base level ² (ft) ²				
wire rope diameter	wire rope length	boom angle	boom extension					boom extension				
			1	2	3	4	5	1	2	3	4	5
1/4 in	20 ft	A	850	850	800	750	725	10	10	10	10	9
1/4 in	20 ft	B	1025	1000	950	875	850	9	9	8	8	8
1/4 in	20 ft	C	1400	1325	1225	1175	1100	8	8	8	7	7
1/4 in	28 ft	A	850	850	800	750	725	18	18	18	18	17
1/4 in	28 ft	B	1025	1000	950	875	850	17	17	16	16	16
1/4 in	28 ft	C	1400	1325	1225	1175	1100	16	16	16	15	15
1/4 in	36 ft	A	850	850	800	750	725	26	26	26	26	25
1/4 in	36 ft	B	1025	1000	950	875	850	25	25	24	24	24
1/4 in	36 ft	C	1400	1325	1225	1175	1100	24	24	24	23	23
1/4 in	45 ft	A	850	850	800	750	725	35	35	35	35	34
1/4 in	45 ft	B	1025	1000	950	875	850	34	34	33	33	33
1/4 in	45 ft	C	1400	1325	1225	1175	1100	33	33	33	32	32
1/4 in	60 ft	A	850	850	800	750	725	50	50	50	50	49
1/4 in	60 ft	B	1025	1000	950	875	850	49	49	48	48	48
1/4 in	60 ft	C	1300	1300	1225	1175	1100	48	48	48	47	47

² See Figure A for lift below base level.

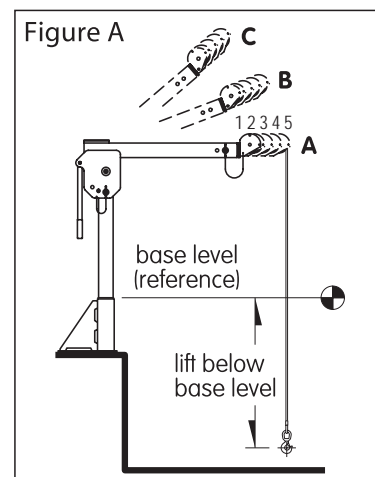



THERN

**Thern, Incorporated
5712 Industrial Park Road
Winona, MN 55987**

**PHN 507-454-2996
FAX 507-454-5282**

**EMAIL: info@thern.com
www.thern.com**